

MAGFORMERS[®]

Intelligent Magnetic Construction Set For Brain Development

R/C CRUISER SET

MAGFORMERS MODEL BOOKLET



MAGFORMERS LLC

HOW TO USE R/C

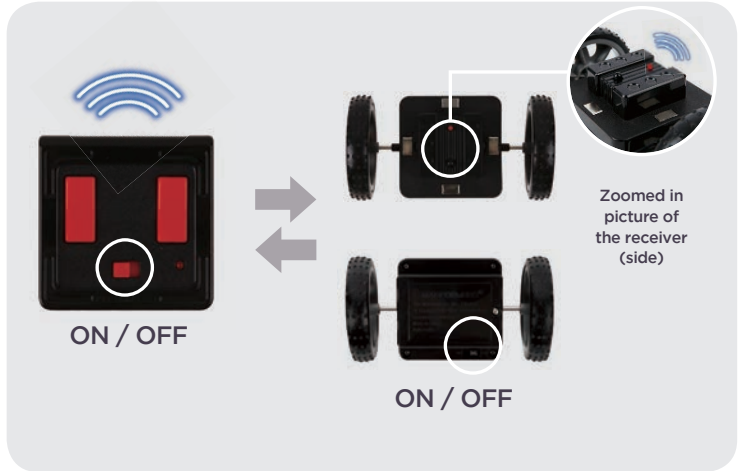

Going forward



Going backward

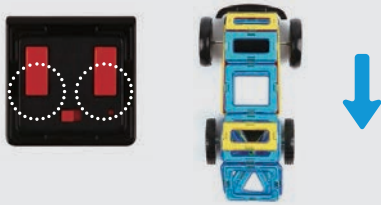

Left turn



Right turn



Sharp turn to the left

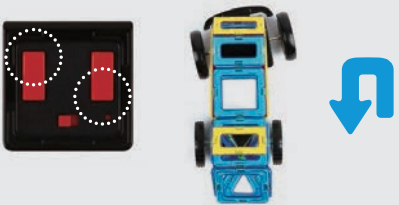

Sharp turn to the right



PULL UP

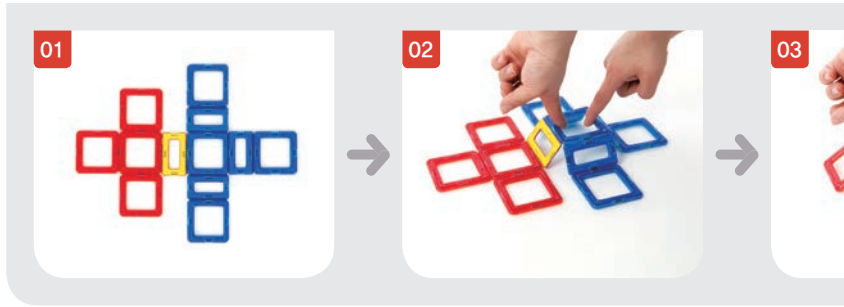

WALL

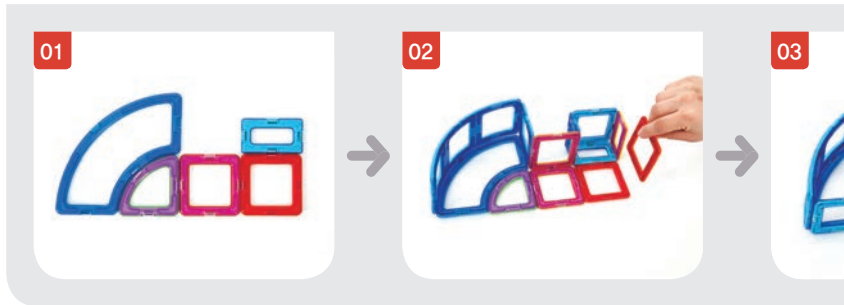

FOLD

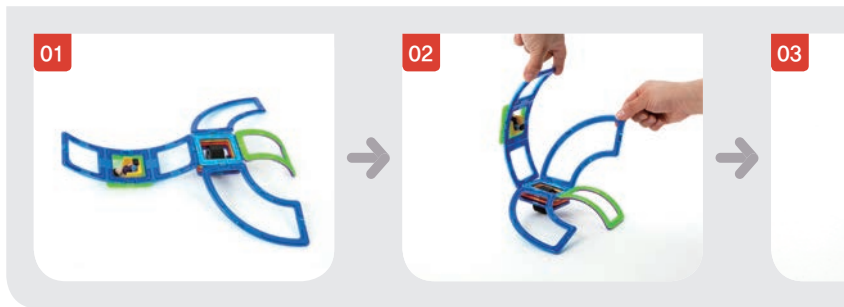



04



04



04



PULL UP

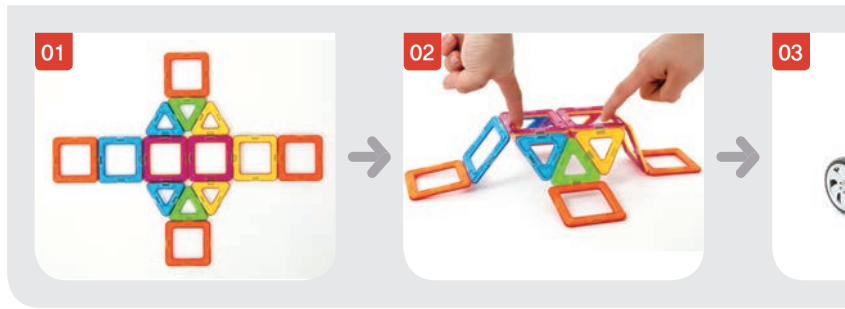

WALL

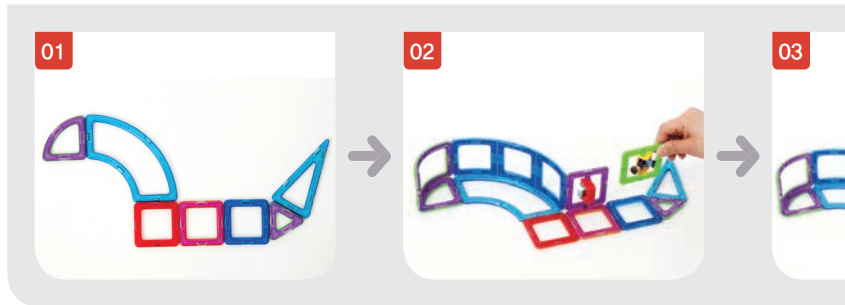

FOLD

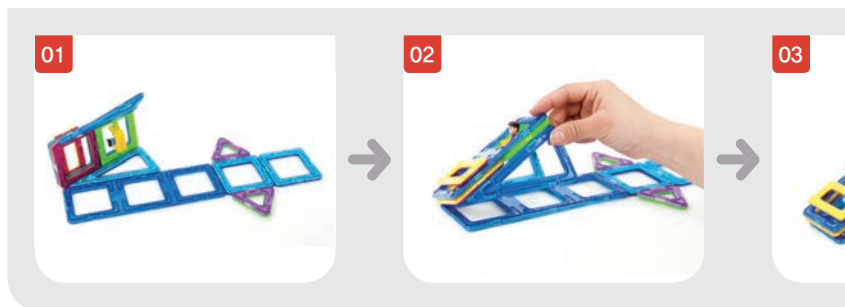



PULL UP

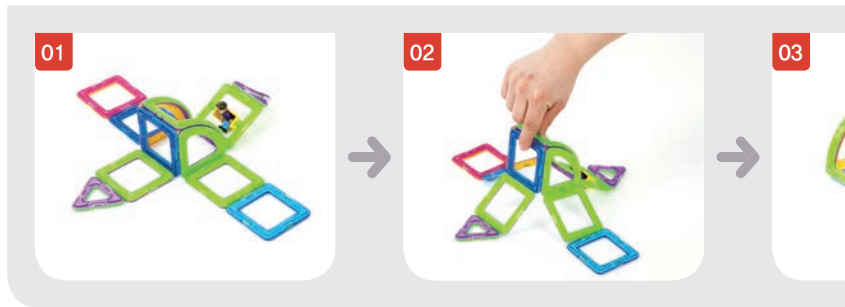

WALL

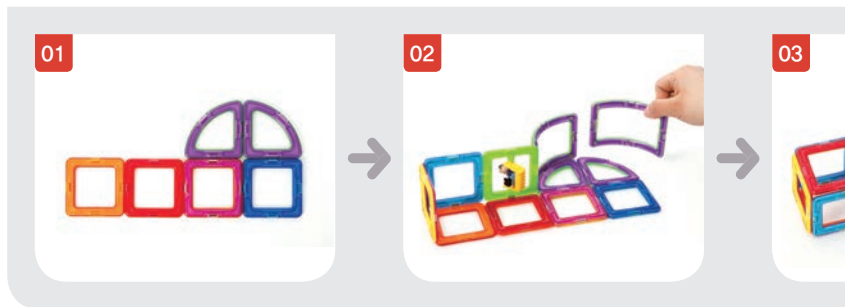

FOLD

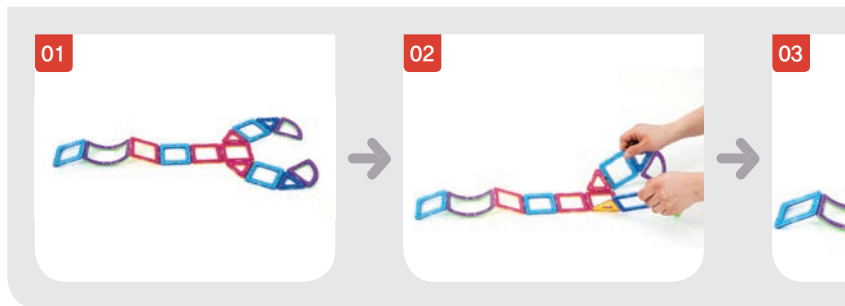



04

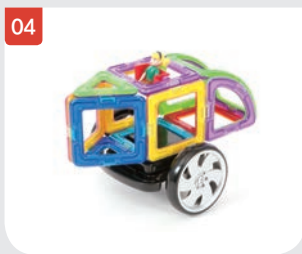

04



04

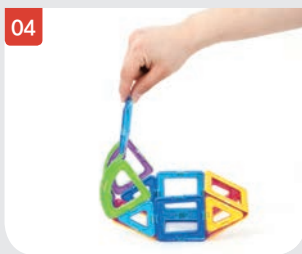

PULL UP

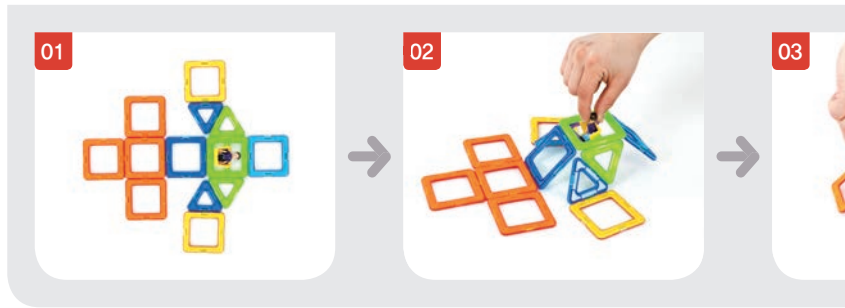

COMBINE

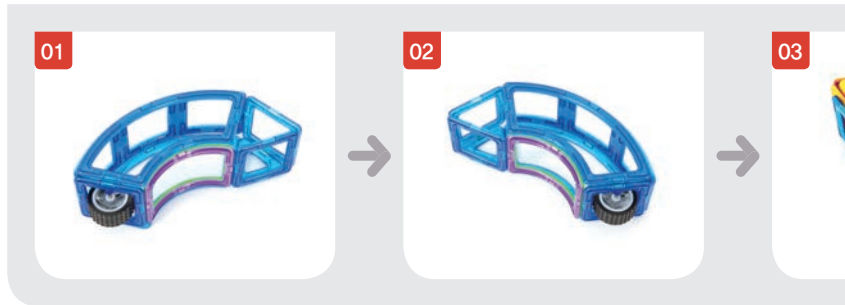

ROLL

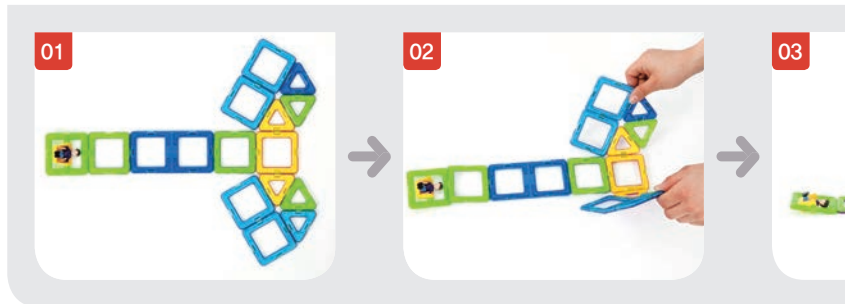



8 TRAFFIC SIGNS (4 CARDS)

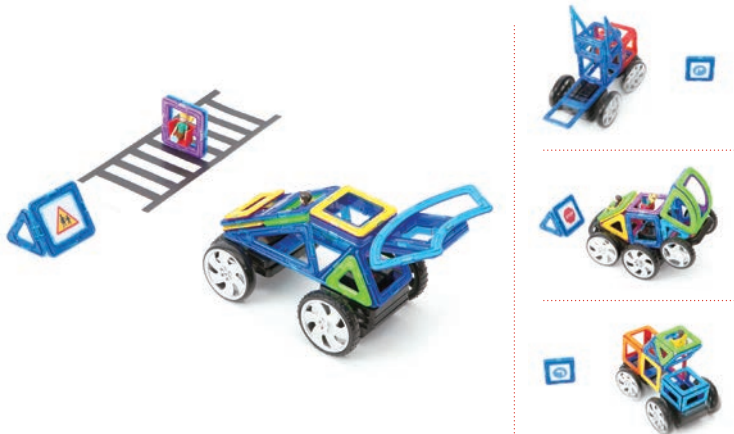
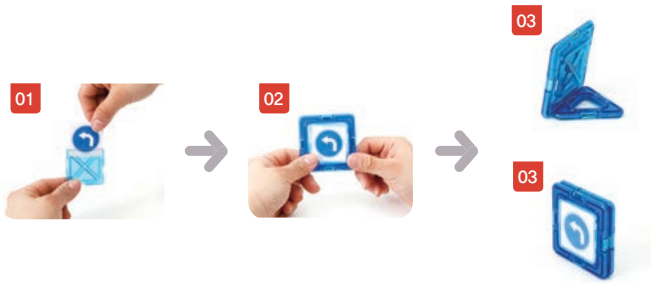

MATCH



•

•



•

•



•

•



•

•



WARNINGS

R/C - Troubleshooting

- If the R/C motor wheel moves slowly or does not work smoothly, there might be a power issue. Please change the batteries.
- Please aim the R/C remote control transmitter towards the receiver of the R/C motor wheel. Please do not cover the transmitter.
- Remote control range is up to 5-8m (16.4-26.2 ft.). However, lagging may occur depending on its operating condition. Please use it within a 3-4m (9.8-13.1 ft.) range.

R/C - Other Warnings

- Please make sure to turn off the power after use since it may drain the battery.
- Control on an actual road may be dangerous, so please only use indoors.
- Please do not throw, or drop Magformers R/C.
- Magformers R/C uses a single frequency. If you use multiple units at the same time, it may cause a malfunction.

Battery Warnings

- If putting a battery in it or using it mistakenly, overheating, rupture and lachrymal fluid could be caused.
- When lachrymal fluid oozes out, never touch it with hands.
- When the fluid which comes out from the battery is stained with the skin or the clothes and gets into the eye, counsel with the doctor immediately.
- Do not mix old and new batteries.
- Do not mix alkaline, standard(carbon-zinc), or rechargeable(nickel-cadmium) batteries.
- Turn off the power when not in use.
- After playing, turn off the power without fail and keep it separate from others.
- Separate the used battery safely.

The battery information

- R/C motor wheel and remote control need 3 AAA batteries each.
- Please insert the batteries according to the marked (+) and (-) poles, and then tighten the screws.
- The battery is not included.

How to remove and insert replaceable batteries.

- Remove screws and place three AAA batteries in the correct position as displayed inside.
- Non-rechargeable batteries are not to be recharged.
- Rechargeable batteries are to be removed from the toy before being charged.
- Rechargeable batteries are only to be charged under adult supervision.
- Batteries are to be inserted with the correct polarity.
- Exhausted batteries are to be removed from the toy.
- The supply terminals are not to be short-circuited.

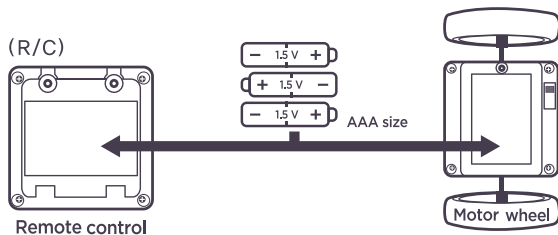

**DISCOVER A WORLD OF
LIMITLESS IMAGINATION,
CREATIVITY AND LEARNING!**

MAGFORMERS construction sets foster brain development through fun and educational exploration. With high quality, durable construction and intelligent magnetic design, the possibilities are endless!





US Patent No. 7,154,363,B2

©2014 MAGFORMERS® LLC. All rights reserved. MAGFORMERS® is a registered trademark of MAGFORMERS® LLC.

Please retain this information for future reference. Please remove all packaging before entrusted to a child.



MAGFORMERS LLC

417 Forest Ave.
Plymouth, MI 48170
Ph. 1-734-667-1673
Fx. 1-888-408-9069

E-Mail: info@magformers.com
facebook.com/magformersllc

This book is a work protected by copyright, thus, any unauthorized copying or reproduction of the content is strictly prohibited. In order to use any or all content, you must receive the consent of MAGFORMERS LLC, the copyright holder and owner of its publication rights.

